

SANTOS & VORTEX AREA BIKE TRAILS

on the Marjorie Harris Carr Cross Florida Greenway

THIS MAP WAS PRODUCED AS A GENERAL REFERENCE GUIDE ONLY.

- LEGEND:**
- = STEEP TRAIL
 - = OMBA PARK BENCH
 - = OGT INFORMATION KIOSK
 - = PARKING
 - = PICNIC AREA
 - = RESTROOMS
 - = WATER
 - = CAMPING
 - = DONATE (PLEASE)
- TREE COVER:**
- = SHADY
 - = SUNNY
- NOTE:**
- A HELMET IS REQUIRED. EYE PROTECTION IS RECOMMENDED.
 - RIDE WITH YOUR HEAD --- NOT OVER IT.
 - A "QUALIFIER" CONTROLS ACCESS TO THE FREERIDE AREA. IF YOU CAN RIDE OVER THE OBSTACLE YOU CAN MOST LIKELY HANDLE THE REST OF THE TRAIL.
 - READ, UNDERSTAND AND OBEY ALL POSTED SIGNS.

- = OMBA YELLOW (EASIEST)
- = OMBA BLUE (MORE DIFFICULT)
- = OMBA RED (MOST DIFFICULT)
- = HIKING
- = HORSE

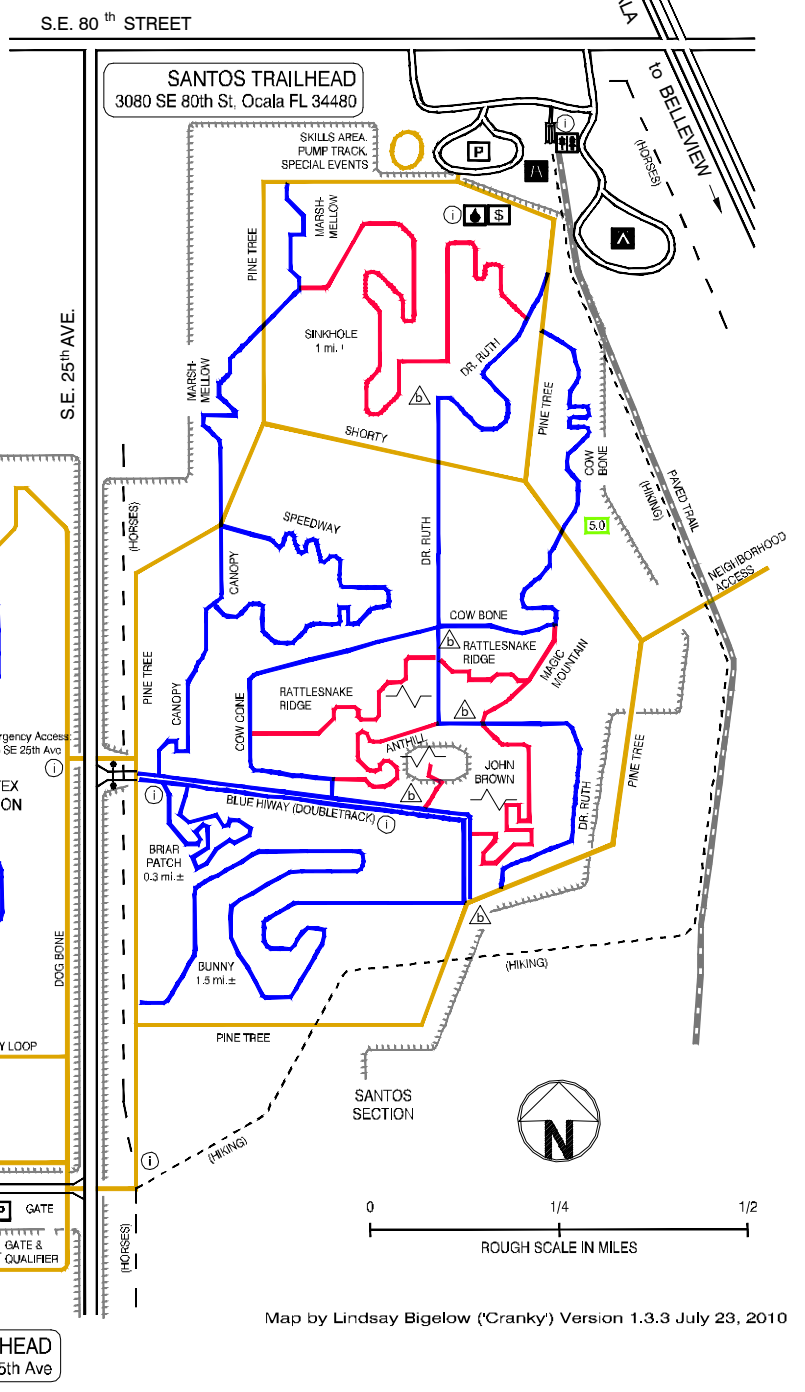

OMBA BIKE TRAILS

on the Marjorie Harris Carr Cross Florida Greenway

THIS MAP WAS PRODUCED AS A GENERAL REFERENCE GUIDE ONLY.

- LEGEND:**
- = STEEP TRAIL
 - = OMBA PARK BENCH
 - = OGT INFORMATION KIOSK
 - = PARKING
 - = PICNIC AREA
 - = RESTROOMS
 - = WATER
 - = CAMPING
 - = DONATE (PLEASE)
- TREE COVER:**
- = SHADY
 - = SUNNY
- NOTE:**
- A HELMET IS REQUIRED. EYE PROTECTION IS RECOMMENDED.
 - RIDE WITH YOUR HEAD --- NOT OVER IT.
 - READ, UNDERSTAND AND OBEY ALL POSTED SIGNS.

- LEGEND:**
- = OMBA YELLOW (EASIEST)
 - = OMBA BLUE (MORE DIFFICULT)
 - = OMBA RED (MOST DIFFICULT)
 - = PAVED TRAIL
 - = LIMEROCK ROAD (SHARED USE)
 - = ESTIMATED ROUTE MILEAGE (BETWEEN)

- NOTE:**
- A HELMET IS REQUIRED. EYE PROTECTION IS RECOMMENDED.
 - RIDE WITH YOUR HEAD --- NOT OVER IT.
 - READ, UNDERSTAND AND OBEY ALL POSTED SIGNS.



Trail Volunteers: www.OMBA.org

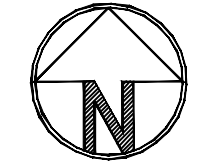

(NOT TO SCALE)



Land Management: <http://www.dep.state.fl.us/parks/>



www.dep.state.fl.us/GWT/



SANTOS BRONZE LEVEL

INTERNATIONAL MOUNTAIN BICYCLING ASSOCIATION RIDE CENTER

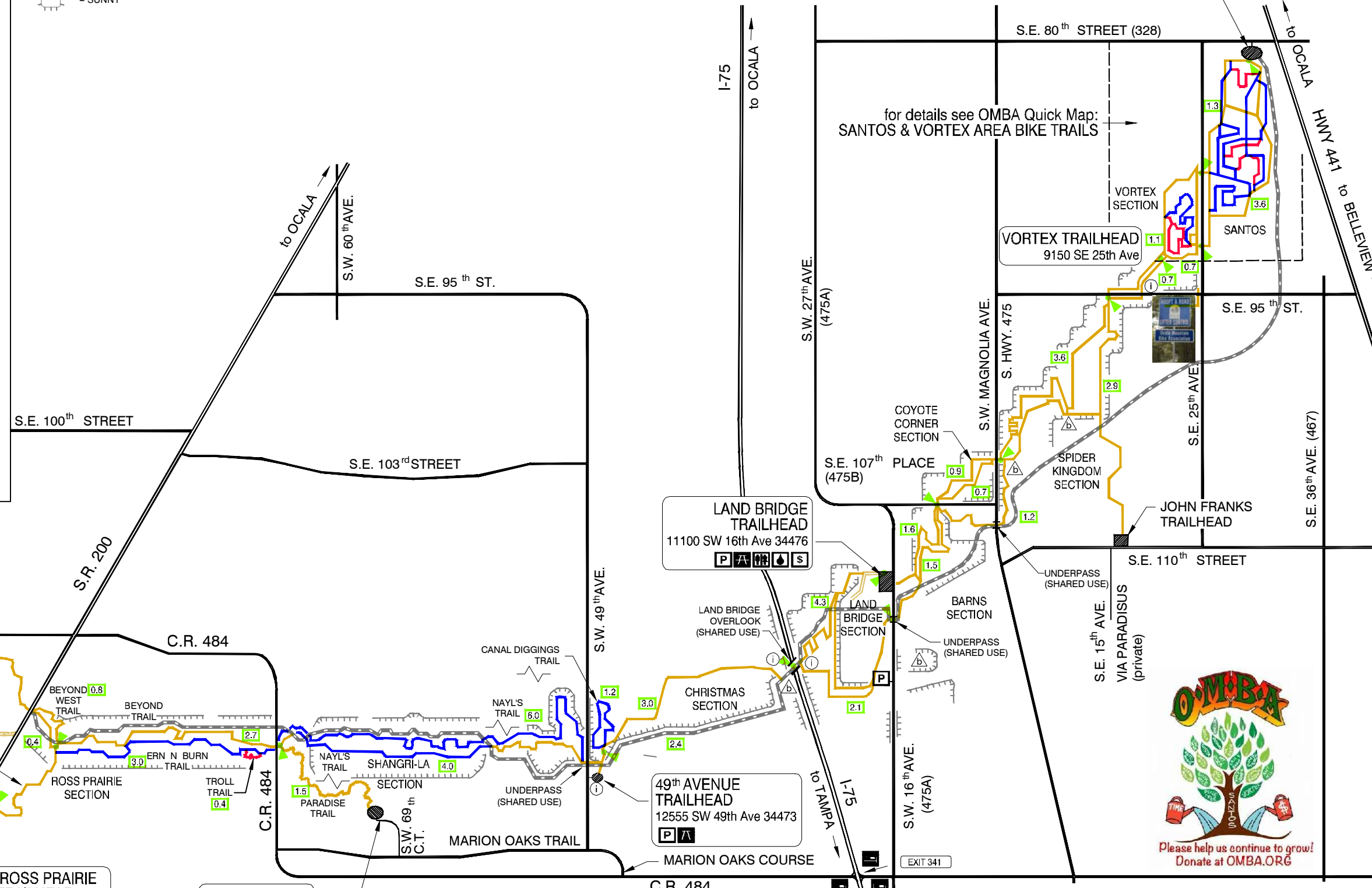

Download this map at www.OMBA.org Help Maintain the trails! Join OMBA!

Map by Lindsay Bigelow ('Cranky') Version 1.3.3 July 23, 2010
Revised By Chris Williams ('Crankier') March 5, 2019